

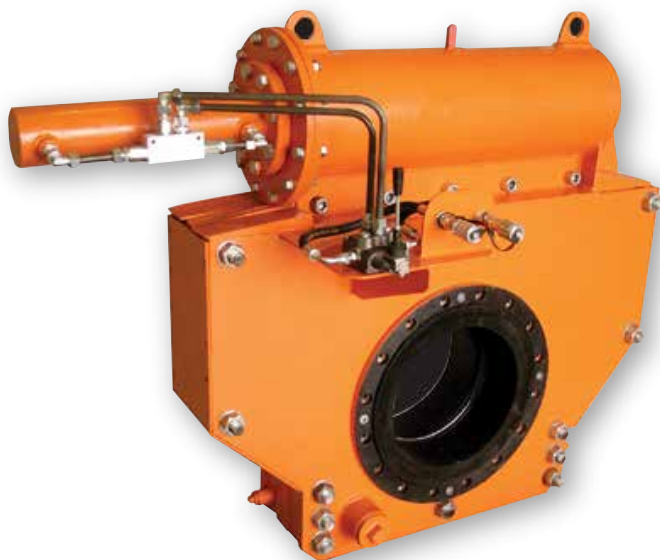

DUAL COMPACT FLANGED PORTED GATE VALVE (DCFPG)

DUAL's Compact Flanged Ported Gate Valve has a stainless steel gate machined with a round orifice hole, in line with seat ID when the valve is in the open position. When the valve is closed the ported gate will move sideways sealing the valve. Due to the seal being constantly engaged against the gate, stroking the valve closed forces the gate progressively between the two matching sleeve ends until it reaches the fully closed position - at which point the sleeves each butt up tightly against either side of the gate, effectively sealing and completely containing the line pressure.

Build up of material to prevent full gate travel is eliminated as there are no areas for such material to accumulate. Any material discharged between the sleeves during stroking open or closed is collected within the containment area of the valve body and drained via the multiple flushing ports in the body. The Ported Gate valve can be used as a man-safe line blanking valve.



FEATURES

- 300 psi (21bar)
- Double seat design for heavy duty slurry service
- Ease of replacement of elastomer sleeves
- Compact body occupies lower installation footprint
- Quick installation
- Self cleaning
- Bubble tight shutoff, zero downstream leakage

- No clogged bonnet to impede flow
- External epoxy coated
- Low maintenance requirements
- O-Port style gate protects the seat face in the open position
- As the valve strokes, the seats will clean the gate of material
- Suitable for wet or dry service
- Bi-directional flow
- Packingless design
- The gate can be coated to eliminate scale build-up
- Light weight for easier handling
- No seat cavity where solids can collect and prevent full gate closure
- Open/close indicator
- Lifting Lugs
- Lock out feature

PRODUCT SPECIFICATION

BODY:	Flanged Pattern cast SG iron GR.42 (SABS) stainless steel or fabricated steel, epoxy coated.
ELASTOMER SLEEVES:	Gum Rubber (standard), Nitrile, Viton, EPDM, Chlorobutyl, Urethane.
RETAINER FLANGES:	Rubber covered carbon steel flanges (80mm thru 600mm).
PRESSURE RATING:	DN80 to DN600 rated to 300 psi (21 Bar) using 316SS gate.
GATE MATERIAL:	316 Stainless Steel standard- 316L, 317L, 17-4PH, Alloy 20, SAF 2205 S/S with optional wear coatings.
DRILLING PATTERNS:	DN80 to DN250 drilled and tapped, ASME B16.5, DIN, SABS and BS. DN300 to DN600 flanges are slotted.
CERTIFICATION: TEMPERATURE RATING:	Certified chemical and physical test reports can be supplied. 90°C maximum.

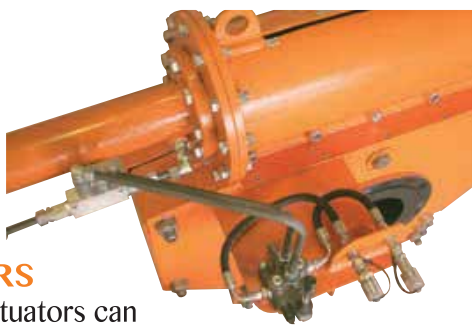

ACTUATORS

All types of actuators can be fitted, electric, gearbox, hydraulic, pneumatic and handwheel.

VALVE BODY - STANDARD FEATURES

- Flush ports on both sides of the valve body
- Protective spindle cover
- Drain ports
- Lubrication ports on both sides of the valve body
- Adaptable (yoke) design can be field modified to take air cylinder, gearbox or hydraulic actuators
- Lock out, ready for factory supplied lock out pin

APPLICATIONS

- Mining and mineral processing
- Power generation
- Sand and gravel
- Chemical and petrochemical
- Pulp and paper
- Environmental and effluent
- Alumina and soda ash

HOW THE RUBBER RING SLEEVE WORKS

Matching rubber ring sleeves with stiffener J-rings are placed in the valve housing to seal against the gate when the valve is in the closed position and seal against the O-Port gate when the valve is in the open position. This tight fit contains the high internal line pressure. Double seated design provides bi-directional flow and shut off.

ACCESSORIES

- Limit switches
- PTFE coating of gate
- Various gate materials optional

INSTALLATION



DIMENSIONS AND WEIGHTS

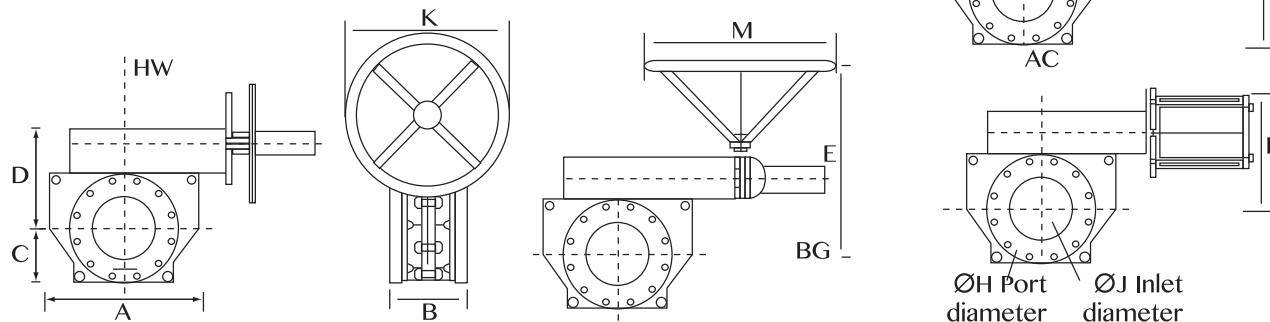

VALVE SIZE (mm)	A0	B	C	HW D	BG E	AC F	HYC G	H0	J0	HW K0	HW/BG M0	VALVE WEIGHT (kg)			
												HW	BG	AC	HYC
80	365	175	124	363	463	363	250	62	72	300	300	50	60	70	70
100	400	175	139	428	528	428	400	85	99	300	300	60	90	100	100
150	490	178	146	525	628	525	500	137	148	500	500	70	100	120	120
200	640	185	179	640	740	640	600	175	197	500	500	100	130	150	150
250	769	226	209	752	852	752	700	231	249	500	500	110	140	180	180
300	891	258	248	890	990	890	810	274	293	600	600	160	190	220	220
350	986	258	274	980	1080	980	910	318	337	600	600	250	280	310	310
400	1220	280	305	1100	1200	1100	1000	356	375	700	700	420	450	490	490
450	1294	312	324	1200	1300	1200	1050	378	426	700	700	490	510	550	550
500	1422	359	368	1325	1450	1325	1200	421	470	700	700	520	550	590	590
600	1676	372	419	1500	1600	1500	1400	539	585	700	700	600	620	690	690

Contact Dual Valves for larger sizes. Dimensions are for guidance only - detailed dimension drawings available on request. All dimensions are in millimeters, unless stated.